

CRAIG®

WIRELESS SPEAKER

One-touch Speakerphone Function

Owner's Manual

PLEASE READ BEFORE OPERATING THIS EQUIPMENT.

Model: CMA3559

FCC INFORMATION:

This equipment has been tested and found to comply with the limits for a Class B digital device, pursuant to Part 15 of the FCC Rules. These limits are designed to provide reasonable protection against harmful interference and residential installation. This equipment generates, uses and can radiate radio frequency energy and, if not installed and used in accordance with the instructions, may cause harmful interference to radio communications. However, there is no guarantee that interference will not occur in a particular installation. If this equipment does cause harmful interference to radio or television reception, which can be determined by turning the equipment off and on, the user is encouraged to try to correct the interference by one or more of the following measures :

- Reorient or relocate the receiving antenna.
- Increase the separation between the equipment and receiver.
- Connect the equipment into an outlet on a circuit different from that to which the receiver is connected.
- Consult the dealer or an experienced radio/TV technician for help.

FCC WARNING:

This equipment may generate or use radio frequency energy. Changes or modifications to this equipment may cause harmful interference unless the modifications are expressly approved in the instruction manual. Modifications not authorized by the manufacturer may void users authority to operate this device.

Note:

Refer all servicing to qualified service personnel. Servicing is required when the unit has been damaged any way such as the following: the power-supply cord or plug has been damaged, liquid has been spilled in to the unit, the unit has been exposed to rain or moisture, the unit has been dropped or the unit does not operate normally.

1. The apparatus shall not be exposed to dripping or splashing and that no objects filled with liquid, such as vases, shall be placed on the apparatus.
2. Where the MAINS plug or an appliance coupler is used as the disconnect device, the disconnect device shall remain operable.

Battery Recharge

The unit has a built in DC \equiv 3.7V, 1000 mAh Li-ion rechargeable battery, recharge it as follow:

- Inset the small plug from the supplied Connection cable to the Micro USB Jack on the rear of unit.
- Insert the other plug to the USB Port on the Personal Computer or any USB Charger having DC \equiv 5V; 500 mA (or more than 500 mA) output as the figure below.

During charging, the Red Indicator on the front panel will light. When finished, it will turn off.

(Personal Computer and USB Charger not included.)

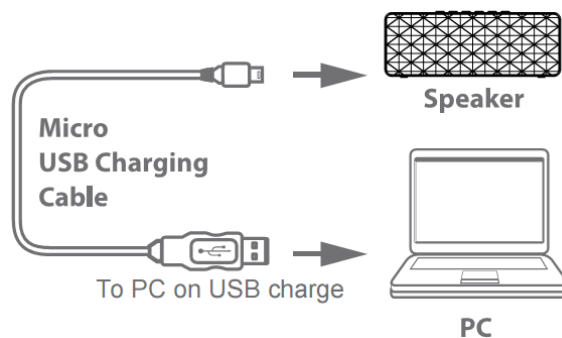

Notes:

Your battery will last longer if you following these simple guidelines for caring for and storing it.

- A. For charging first time, charge it at least 10 hours.
- B. Recharge and store the battery within the temperature range of 5°C~35°C (40°F~95°F).
- C. Do not over charge (longer than 24 hours). Excessive charging or discharging may shorten the battery's life.
- D. Battery life naturally shortens slowly over time.
- E. The rechargeable battery incorporated in this product is not user replaceable.

Location of Controls:

TOP VIEW

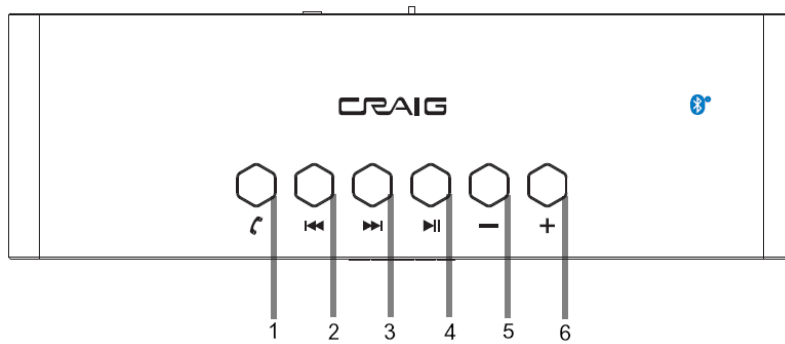

FRONT VIEW

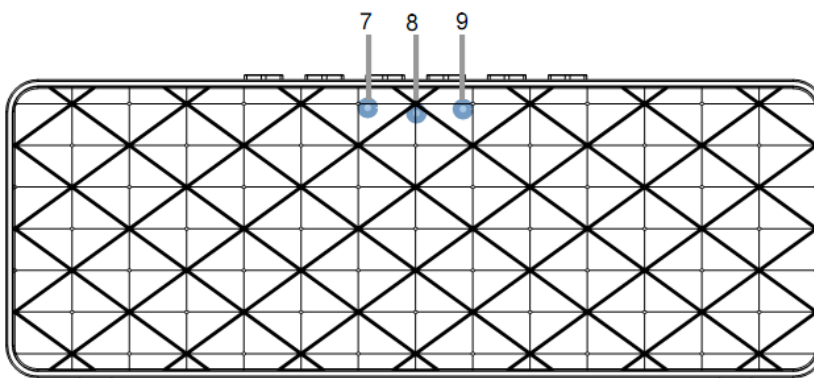

BACK VIEW

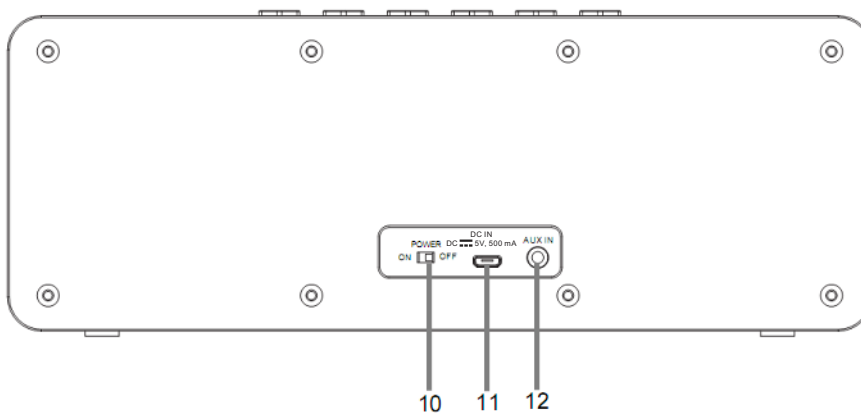

- | | |
|-----------------------------------|--|
| 1. 📞 (Phone's Hook ON/OFF) Button | 7. Power On Indicator |
| 2. ⏮ (Previous) Button | 8. Microphone |
| 3. ⏭ (Next) Button | 9. Charge Indicator |
| 4. ⏸ (Play/Pause) Button | 10. Power ON/OFF Switch |
| 5. - (Volume Down) Button | 11. Micro USB Port (For Charging only) |
| 6. + (Volume Up) Button | 12. AUX IN Jack |

OPERATION

In first time use or re-pairing to new BT Device, pairing the unit to external BT Device as below:

1. Slide the Power ON/OFF Switch on the rear of unit to ON position. Blue Indicators on the front panel will light and blinking.
Important: Make sure the Audio connection cable haven't inserted to the AUX IN Jack on the rear of unit. Otherwise, the unit will turn to AUX IN mode. BT will not functioning.
2. Power on the external BT Device and enter to searching mode. Start pairing as the on screen instructions on the external BT Device. After paired, the Blue Indicator will stop blinking. (For details pairing procedures, please refer to the user's manual of your BT Device).

Notes:

- When the external BT player searched the unit, our model number "CMA 3559" will appear on the display of external BT Device.
- Pairing code "0000" may need to enter.

Normal operation after pairing:

1. Turn on the BT function of the external BT Device.
2. Slide the Power ON/OFF Switch to ON position to power on the unit. The Blue Indicator on the front panel will light, wait until the Blue Indicators is stop blinking. (It needs take a few seconds).
3. Plays the music in the connected BT Device as usual.
4. During playback:
 - Press the + or – (Volume Up or Down) Buttons to adjust volume level as desire.
 - Press the ►|| (Play/Pause) Button to pause; press again to resume.
 - Press and release the ◀◀ or ▶▶ Button to skip tracks.
5. If the unit was paired to a Cell Phone:
 - When a call is incoming during listening, press the 📞 Button to hook off then speak to the built-in microphone on the top of front panel to answer the phone. When finished, press the 📞 Button to hook on then resume to music playback.
 - Press and hold the 📞 Button for last number redialing.
6. When finished listening, slide the Power ON/OFF Switch to OFF position to shut off the unit.

AUX IN:

To listening from the external Music player such like MP3 Player, Disc-man ...etc.

1. Slide the Power ON/OFF Switch to ON position to power on the unit. The Blue Indicator on front panel will light.
2. Connect one end of the supplied Audio Connection Cable to the Line Out; AUX Out or Phones Jack of the external audio player.
3. Insert other end of the supplied Audio Connection Cable to the AUX IN Jack on the rear of unit. The unit will turn to AUX IN mode automatically.
4. Plays the music in the connected Player as usual. (Make sure the volume level of the connected music Player is turned to high level. Otherwise, sound is weak).
5. During playback, press and hold the + or – (Volume Up or Down) Buttons to adjust volume level as desire.
6. When finished listening, slide the Power ON/OFF Switch to OFF position to shut off the unit.

Troubleshooting:

Can't power on	Built in battery consumed	Recharge the battery.
No sound or sound weak	Volume of the unit was set to minimum position	Increase the volume level by press the + Button.
	Volume of paired/connected device is in low volume level	Rise the volume level of the paired BT device or connected audio player

Specification

Power Source	Built-in DC --- 3.7V, 1000 mAh Li-ion rechargeable battery. Recharge by DC --- 5V; 500mA through Micro USB Port.
Maximum Play time	Up to 4 hours after fully charged
BT Effective range	Up to 30 feet in open area
Audio Power	3 W per channel
Impedance of Speakers	4 W; 4 Ohm x 2

SPECIFICATIONS ARE SUBJECT TO CHANGE WITHOUT NOTICE

Accessories:

1 x User's Manual

1 x USB Connection cable (For charge only)

1 x Audio Connection Cable with 3.5mm stereo mini plugs

LIMITED WARRANTY

Craig warrants this product to be free from manufacturing defects in material and workmanship under normal use for a period of 90 days from date of purchase. If service is required, please return the product to the store where it was purchased for exchange; or, pack the unit in the original packing material with all accessories if applicable, a copy of your sales receipt and a Cashier's check or Money Order for \$10.00 (to cover shipping and handling costs) payable to Craig Electronics Inc. For consumers in Canada, please make sure that the cashier check or money order is redeemable through a U.S. bank. Ship your product freight pre-paid. Your unit will be repaired, replaced or if the unit can not be repaired or replaced, a refund will be forwarded to you within four weeks of receipt of your unit. Please ship your unit to:

Craig Electronics Inc.
1160 NW 163 Drive
Miami, FL 33169

This warranty is void if the product has been: a) Used in a commercial application or rental. b) Damaged through misuse, negligence, or abuse. c) Modified or repaired by anyone other than an authorized Craig service center. d) Damaged because it is improperly connected to any other equipment.

Note: This warranty does not cover: a) Ordinary adjustments as outlined in the Owner's Manual which can be performed by the customer. b) Damage to equipment not properly connected to the product. c) Any cost incurred in shipping the product for repair. d) Damage to the product not used in the USA.

This warranty is not transferable and only applies to the original purchase. Any implied warranties, including the warranty of merchantability, are limited in duration to the period of this expressed warranty and no warranty whether expressed or implied shall apply to the product thereafter.

Under no circumstance shall Craig be liable for any loss or consequential damage arising out of the use of this product. This warranty gives specific legal rights. However, you may have other rights which may vary from state to state. Some states do not allow limitations on implied warranties or exclusion of consequential damage. Therefore, these restrictions may not apply to you.

To Obtain Service on your Product
email: service@craigelectronics.com